



ADDENDUM #1
CID-RI – Phase 2 Roadway
SCO # 12-09457-02A
January 20, 2015

Project:

The University of North Carolina at Charlotte
Campus Infrastructure Development—Roadway Improvements (CID-RI) – Ph. 2
SCO# 12-09457-02A
Code 41226
Item 301A

Information contained herein is intended to clarify previously issued information and shall become part of the above referenced project documents.

Attachments:

1. Meeting Notes – Pre-bid Meeting on January 13, 2015.
2. Pedestrian Phasing Plans.
3. UNC Charlotte “Good Faith Effort” Requirements (Jan 2015)

Clarifications:

1. UNC Charlotte “Good Faith Effort” Requirements
 - a. The HUB participation goal for this project is fifteen percent (15%).
 - b. Insert Section “Article 49 – MINORITY BUSINESS PARTICIPATION” into the SGC’s, which shall include statement:
 - i. “The HUB participation goal for this project is fifteen percent (15%). Any reference in this Contract to 10% as the project goal shall be superseded by this requirement.”
 - c. Contractor to comply with items outlined in included attachment.
2. Completion Date:
 - a. Contractor, if selected, will be required to complete the work by August 21, 2015 with no exceptions.
 - b. The Contractor is urged to expeditiously get under contract while remaining in compliance with all University contracting procedures.
3. Work during Summer:



ADDENDUM #1

CID-RI – Phase 2 Roadway

SCO # 12-09457-02A

January 20, 2015

- a. The Contractor will be required to perform Lot 23 work and work near Phase V, Elm Hall only during the summer timeframe between May 10, 2015 and August 21, 2015.
4. Contractor Parking:
 - a. Contractor parking will be permitted at the offsite location referred to in the Contract Documents (Regal Starlight Theater). Contractor will not be allowed to park on the construction sites.
 - b. The Contractor will have the option to buy a parking permit directly from Parking & Transportation Services and will be instructed where and when the permit is valid.
5. Soils:
 - a. The Contractor will be required to follow University soil specifications, including but not limited to type of material, allowable size, and compaction.
6. Rip-Rap on Mary Alexander:
 - a. The Contractor is to reset or replace any rip-rap impacted by wall, rail or electrical construction along Mary Alexander, Sheet RD-33 of the plans.
 - i. The Contractor is not allowed to work in any creeks or streams in or near the project limits.
7. Bus Shelters/Pads:
 - a. The Contractor will be required to remove the bus shelters from their current locations while the new bus shelter pads are constructed. The contractor will be required to remove the existing concrete foundation and replace with the brick (in standard herringbone pattern) as shown in the plans. For new bus shelter locations, the Contractor will be responsible for installing the brick pads as shown in the plans. The Contractor will be required to reset all bus shelters.
8. Irrigation Additional Specifications:
 - a. Contractor to provide backflow preventer and power for irrigation at Mary Alexander and Craver intersection...
 - i. Changes to Electrical Documents:
 1. Revised sheet: Attached sheet E-22 has been revised per Revision #2, 1-20-2015 date.
 2. Other revisions to drawings are as described here:



ADDENDUM #1

CID-RI – Phase 2 Roadway

SCO # 12-09457-02A

January 20, 2015

- a. Sheet E-01: Under “Lighting Fixture Schedule”, Fixture type “SB” add the word “New” as the first word for the description of this fixture.
- b. Sheet E-04: Change designation of two pole light fixtures shown near southwest corner of Phillips Baseball Field from “SA” to read “SB”.
- c. Sheet E-12: Show location of new irrigation controller at the junction of Carver and Mary Alexander Roads, at approximately 50 feet south from centerline of Carver Road and 50 feet west from centerline of Mary Alexander Road. Provide new NEMA 5-20R duplex WP/GFI receptacle adjacent to, or within, irrigation controller enclosure, as directed by irrigation system installer. Connect with 2#8, 1#8G-1”C, 120 volt circuit, that shall be run underground to new 20A, 1-Pole, circuit breaker within new power control assembly “NSPH” on the exterior wall of steam plant building, per Sheet E-13 and details 3/E-22 and 4/E-22. Provide intermediate 12” x 12” x 12” quazite pull boxes to limit any conduit run to maximum of 270 degree equivalent conduit elbows.
- d. Sheet E-12: Change keyed note “5” to read: “New 2 #8 (277V), 2 #8 spare, 1#8G-1”C to new 15A, 1-pole circuit breaker in power/control assembly “NSPH”.
- e. Sheet E-13: Show new conduit to irrigation controller from “NSPA”, per description to changes to sheet E-12 above.
- f. Sheet E-15: Add designation “SC” to existing pole lighting symbol shown about 120 feet south of identified 25-foot pole light “SC”.

9. Traffic Control Phasing:

- a. If Contractor has an example of a preferred traffic control phasing, then Contractor to submit approach for Designer and Owner review. The revised phasing must meet all UNC Charlotte requirements.

10. Steam Vault:

- a. Existing Steam vault and valves at STA 319+00 LT will require a new traffic bearing lid as part of the adjustment. The existing concrete vault has an inside



ADDENDUM #1
CID-RI – Phase 2 Roadway
SCO # 12-09457-02A
January 20, 2015

dimension of 6' X 6'. The proposed traffic bearing lid will be based on the lid design for NCDOT Std. 840.34. The contractor will be responsible for measuring the locations of the existing manholes and valves of the vault to construct the new vault. Contractor to assume an overall slab width of 1'-2". Concrete shall be NCDOT Class AA concrete. #6 bars at 9" OC will be required in both directions in a top mat and bottom mat.

11. Metal Safety Rail:

- a. Detail shown in plans shows 1" X 1.5" bar stock. The University will accept 1-1/2" Max O.D. pipe in lieu if the bar stock.

12. Speed Bumps/Humps

- a. Contractor is to remove all speed bumps/humps on Craver.

13. Accessible Pedestrian Pathways

- a. Contractor is to maintain all accessible pedestrian pathways through May 10, 2015.

14. Updates to Plan Sheets:

- a. RD-14 – Change 95% minimum compacted subgrade to 98%.
- b. RD-24 – Assume 15' x 50' full depth asphalt patch on Craver near station 308+00.
- c. RD-31 – Contractor to remove existing asphalt walk along Cameron Blvd between Ph. XII housing and Mary Alexander.
- d. RD-33 – Contractor is to reset or replace any rip-rap impacted by wall, rail or electrical construction along Mary Alexander.
- e. RD-76 – Contractor is to include 4" white thermoplastic Mini-skip "TD" on Cameron Boulevard westbound across Mary Alexander road from ~Sta 704+50 to 705+50 to delineate bike lane through intersection.
- f. UT-09 – Contract to see language included above in "Steam Vault" section of this addendum to describe the work.



ADDENDUM #1

CID-RI – Phase 2 Roadway

SCO # 12-09457-02A

January 20, 2015

Contractor Questions:

1. How will the low bidder be determined? Will it be the lowest of all four alternates combined? OR is each alternate treated as a separate contract, with the potential of having multiple contractors amongst all the alternates?
 - a. Low bidder will be determined by sum of alternates selected for construction.
2. Will the alternates be awarded based on importance and/or funding available? OR does UNCC intend to award all four alternates?
 - a. The University intends to award all four alternates. However, the University reserves the right to award the alternates based on available funds.
3. Can you clarify where the University wants fence around the construction site for the alternate bids?
 - a. The construction fence requirements are noted in the attached pedestrian phasing plans.
 - b. The Contractor shall provide barrier protection between vehicular traffic and pedestrian traffic and orange construction fencing between construction zones and adjacent pedestrian pathways and walkways with appropriate barricades to deter pedestrian traffic through any work zone.
 - c. Section 015000 of the General Requirements requires fencing around all work zones.

END OF ADDENDUM 1

MEETING NOTES

SUBJECT: CID-RI – Phase 2
- Pre-Bid

DATE: January 13, 2015

SCO #: 120945702A

PROJECT: CID-RI

TIME: 2:00pm

PLACE: UNC Charlotte – Cone University Center Room 112
Code 41126 Item 301A

ATTENDEES

Brian Kugler
Jennifer Price
Dorothy Vick
Steve Blakley
Gabe Dobbs
Benjamin Taylor
Richie McCullough
Jason Bree
Rob Davis
Rob Johnson
James Polleti
Eve Hibbler
Bill Brassil
Kyle Bowker
Todd Price
Stuart Hughes

REPRESENTING

UNC Charlotte
UNC Charlotte
UNC Charlotte
Kimley-Horn and Associates, Inc. (KHA)
KHA
KHA
Badger Daylighting
Sealand Contractors Corp.
Bryant Electric (BERCO)
DeVere Construction
Granite Contracting
Blythe Development
Ridgerock Retaining Walls
Carolina Conduit Systems
Blythe Construction
Pedulla

E-MAIL

bhkugler@uncc.edu
Jevans83@uncc.edu
dlvick@uncc.edu
Steve.blakley@kimley-horn.com
Gabe.dobbs@kimley-horn.com
Ben.taylor@kimley-horn.com
rmccullough@badger-corp.com
Jason.bree@sealandcontractors.com
RobD@bercoinc.net
estimating@deverecs.us
Jamespolleti@granitecontracting.com
ehibbler@blythedevelopment.com
billb@ridge-rock.com
kbowker@carolinaconduit.com
Todd.price@blytheconstruction.com
stuart@pedullaexcavating.com

GENERAL SEQUENCE OF DISCUSSIONS

- All attendees introduced themselves and stated their employer.
- The design team went over the project including the alternatives
 - Ben gave overview of Base Bid (not in this bid) and each alternate (1-4)
- Contractor parking will be permitted at the offsite location referred to in the Contract Documents (Regal Starlight Theater). Contractor will not be allowed to park on the construction sites.
- The Contractor will have the option to buy a parking permit directly from Parking & Transportation Services and will be instructed where and when the permit is valid.
- HUB: Dorothy Vick covered HUB requirements. Requirements follow SCO, not NCDOT
 - The HUB participation goal for this project is fifteen percent (15%).
 - Dorothy provided handout to each Contractor – “Good Faith Effort” Requirements

- Ben discussed Agenda items:
 - There was no formal tour of the project – Contractors may visit on their own.
 - Construction phasing - If Contractor has an example of a preferred traffic control phasing, then Contractor to submit approach for Designer and Owner review. The revised phasing must meet all UNC Charlotte requirements.
 - Handrail - Detail shown in plans shows 1" X 1.5" bar stock. The University will accept 1-1/2" Max O.D. pipe in lieu of the bar stock.
 - Steam MH – Detail or description of work to be provided in addendum for bidding purposes.
 - Schedule
 - 1/13 (Today) – Prebid
 - Questions are due Friday 1/16
 - 1/20 –Addenda issued
 - 1/27– Bid opening
 - Contract Completion: 8-21-2015
- Contractor, if selected, will be required to complete the work by August 21, 2015 with no exceptions.
- Some portions of the work need to be constructed in the summer (5-10-15 to 8-21-15).
- The Contractor is urged to expeditiously get under contract while remaining in compliance with all University contracting procedures.
- Low bidder will be determined by lump sum bid of Alternates 1-4.
- Ben reminded Contractors to read University specifications on compaction.
- No work will be allowed in creeks or streams in project limits or adjacent to project.

MEETING CLOSED

These comments were prepared by Kimley-Horn and Associates with the intent to capture the main body of discussion with supporting facts and results from the subject meeting. Should your recollection of the events and discussion of this meeting differ, please forward your revisions and/or additions to Benjamin Taylor [Benjamin.taylor@Kimley-Horn.com] so that he may amend and/or modify this summary to be more accurate. Thank you.

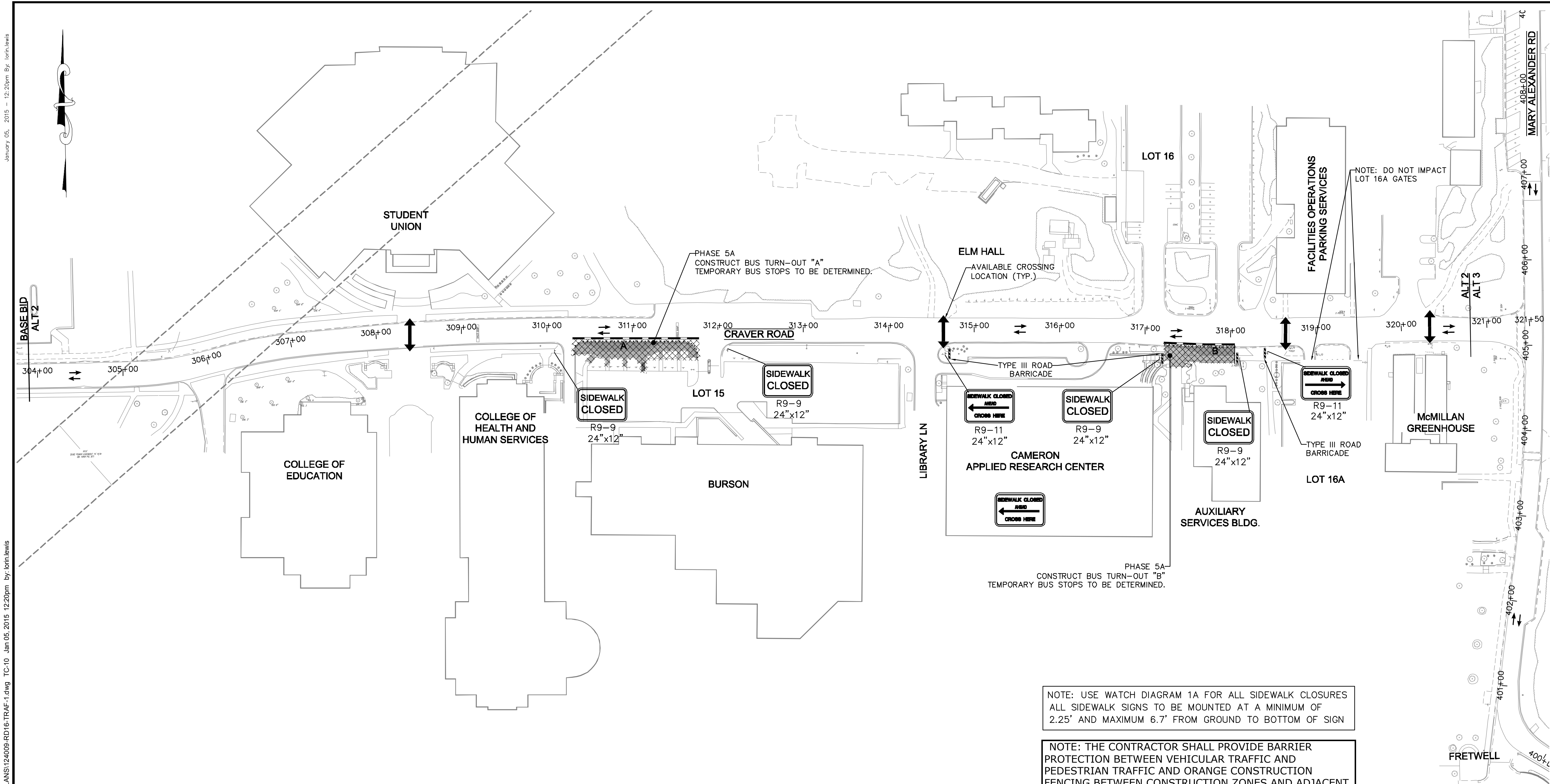

TRAFFIC CONTROL LEGEND	
	FLASHING ARROW PANEL (TYPE C)
	PORTABLE MESSAGE SIGN
	SKINNY DRUM
	DIRECTION OF TRAFFIC FLOW
	PORTABLE SIGN
	TYPE III ROAD BARRICADE
	FLAGGER
	CONSTRUCTION FENCE
	CONCRETE BARRIER
	WORK AREA

CONSTRUCTION SEQUENCE:
ALT 2

- PHASE 1:
STEP 1: INSTALL ALL ADVANCE WARNING SIGNAGE AND OTHER TRAFFIC CONTROL DEVICES THROUGHOUT PROJECT PRIOR TO BEGINNING CONSTRUCTION ACCORDING TO THE APPROPRIATE WATCH DIAGRAMS.
- STEP 2: INSTALL EROSION CONTROL MEASURES THROUGHOUT THE PROJECT IN ACCORDANCE WITH THE EROSION CONTROL PLANS.
- STEP 3: CONSTRUCT NEW CURB, GUTTER, SIDEWALK, DRAINAGE STRUCTURES, AND ASPHALT ALONG THE SOUTH SIDE OF CRAVER ROAD. MAINTAIN AT LEAST ONE THROUGH LANE IN EACH DIRECTION ALONG CRAVER ROAD. USE WATCH DIAGRAMS 4 AND 5 AS NECESSARY.
- STEP 4: CONSTRUCT NEW CURB, GUTTER, SIDEWALK, DRAINAGE STRUCTURES, AND ASPHALT ALONG THE NORTH SIDE OF CRAVER ROAD. MAINTAIN AT LEAST ONE THROUGH LANE IN EACH DIRECTION ALONG CRAVER ROAD. USE WATCH DIAGRAMS 4 AND 5 AS NECESSARY.
- STEP 5: INSTALL FINAL PAVEMENT COURSE, FINAL PAVEMENT MARKINGS AND SIGNAGE.

TEMPORARY PAVEMENT MARKING LEGEND

PAVEMENT MARKING LINES	
PA	WHITE EDGELINE
PB	WHITE PAVEMENT SYMBOL MARKINGS
PI	YELLOW DOUBLE CENTER LINE
	PAINT (4")
NOTE: CONTRACTOR TO REMOVE ALL CONFLICTING PAVEMENT MARKINGS	

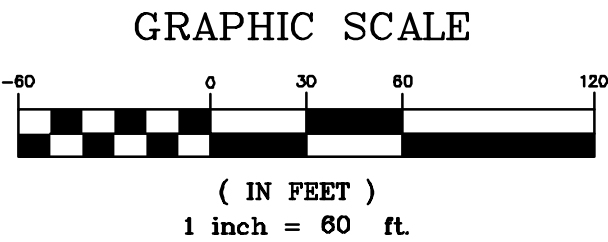

Know what's below.
Call before you dig.

Kimley»Horn
NC License #F-0102
2000 SOUTH BOULEVARD
SUITE 440
CHARLOTTE, NORTH
CAROLINA 28203
PHONE: (704) 333-5131
© 2014

DRAFT

NO.	DATE	REVISIONS

CLIENT:

9201 UNIVERSITY CITY BOULEVARD
CHARLOTTE, NC 28223

PROJECT:
THE UNIVERSITY OF
NORTH CAROLINA AT CHARLOTTE
ROADWAY IMPROVEMENTS
CID-RI
CODE 41226 ITEM 301A
PROJECT ID#12-09457-02A

TITLE:
**TRAFFIC CONTROL
PHASE 5A**

DESIGNED BY: LL/GD
DRAWN BY: DH
CHECKED BY: BT
DATE: 12/12/2014
PROJECT#: 015124009

TC-10

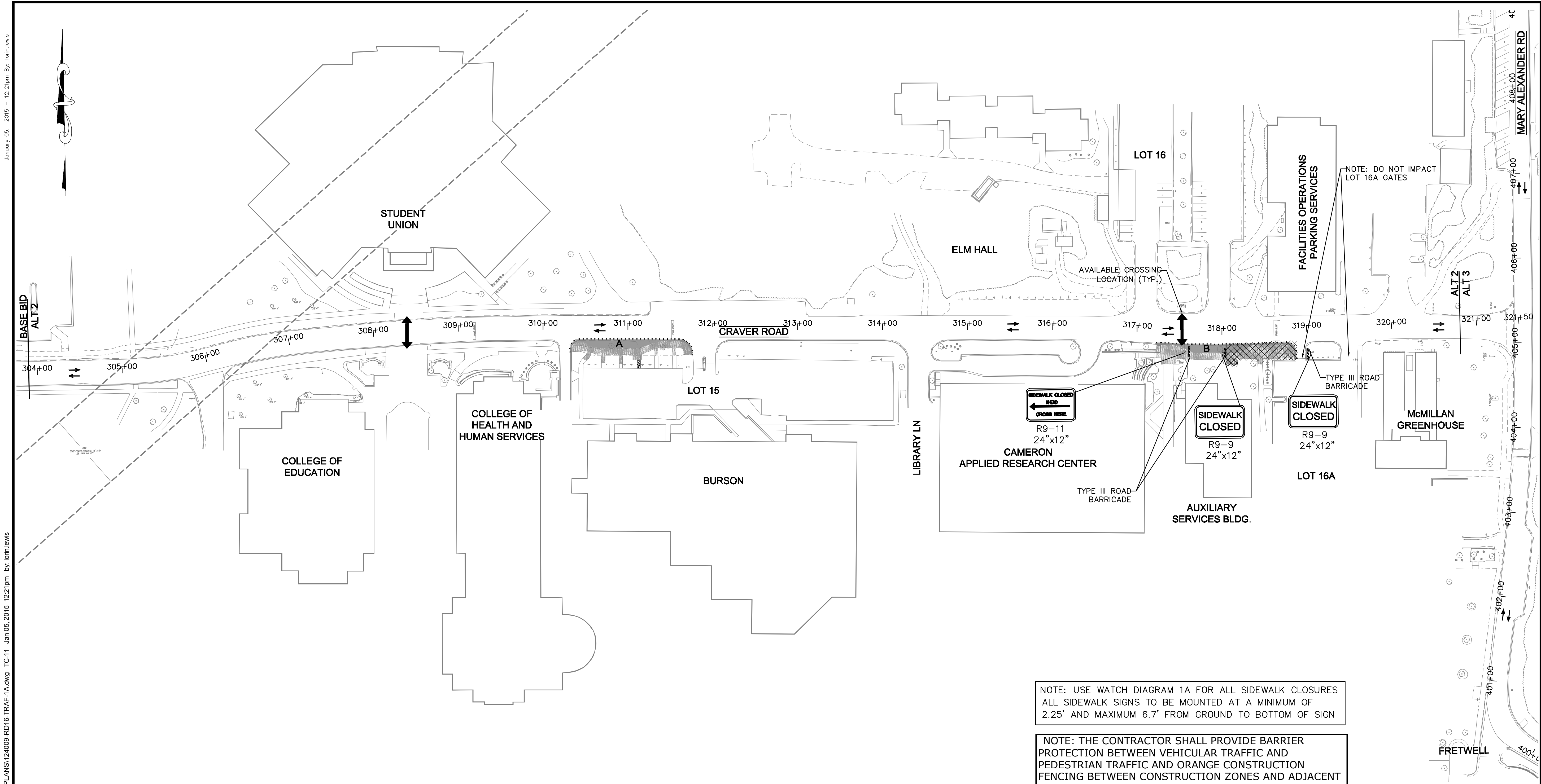

TRAFFIC CONTROL LEGEND	
	FLASHING ARROW PANEL (TYPE C)
	PORTABLE MESSAGE SIGN
	SKINNY DRUM
	DIRECTION OF TRAFFIC FLOW
	PORTABLE SIGN
	TYPE III ROAD BARRICADE
	FLAGGER
	CONSTRUCTION FENCE
	CONCRETE BARRIER
	WORK AREA

CONSTRUCTION SEQUENCE:
ALT 2

- PHASE 1:
STEP 1: INSTALL ALL ADVANCE WARNING SIGNAGE AND OTHER TRAFFIC CONTROL DEVICES THROUGHOUT PROJECT PRIOR TO BEGINNING CONSTRUCTION ACCORDING TO THE APPROPRIATE WATCH DIAGRAMS.
- STEP 2: INSTALL EROSION CONTROL MEASURES THROUGHOUT THE PROJECT IN ACCORDANCE WITH THE EROSION CONTROL PLANS.
- STEP 3: CONSTRUCT NEW CURB, GUTTER, SIDEWALK, DRAINAGE STRUCTURES, AND ASPHALT ALONG THE SOUTH SIDE OF CRAVER ROAD. MAINTAIN AT LEAST ONE THROUGH LANE IN EACH DIRECTION ALONG CRAVER ROAD. USE WATCH DIAGRAMS 4 AND 5 AS NECESSARY.
- STEP 4: CONSTRUCT NEW CURB, GUTTER, SIDEWALK, DRAINAGE STRUCTURES, AND ASPHALT ALONG THE NORTH SIDE OF CRAVER ROAD. MAINTAIN AT LEAST ONE THROUGH LANE IN EACH DIRECTION ALONG CRAVER ROAD. USE WATCH DIAGRAMS 4 AND 5 AS NECESSARY.
- STEP 5: INSTALL FINAL PAVEMENT COURSE, FINAL PAVEMENT MARKINGS AND SIGNAGE.

TEMPORARY PAVEMENT MARKING LEGEND

PAVEMENT MARKING LINES	
PA	WHITE EDGELINE
PB	WHITE PAVEMENT SYMBOL MARKINGS
PI	YELLOW DOUBLE CENTER LINE
	PAINT (4")
	PAINT (4")
NOTE: CONTRACTOR TO REMOVE ALL CONFLICTING PAVEMENT MARKINGS	

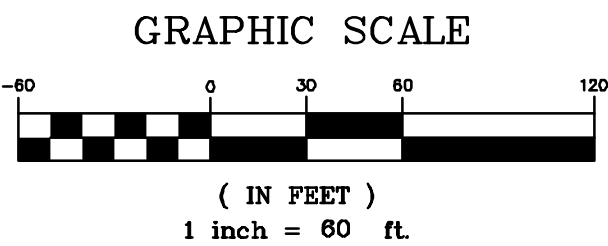

NOTE: USE WATCH DIAGRAM 1A FOR ALL SIDEWALK CLOSURES
ALL SIDEWALK SIGNS TO BE MOUNTED AT A MINIMUM OF 2.25' AND MAXIMUM 6.7' FROM GROUND TO BOTTOM OF SIGN

NOTE: THE CONTRACTOR SHALL PROVIDE BARRIER PROTECTION BETWEEN VEHICULAR TRAFFIC AND PEDESTRIAN TRAFFIC AND ORANGE CONSTRUCTION FENCING BETWEEN CONSTRUCTION ZONES AND ADJACENT PEDESTRIAN PATHWAYS AND WALKWAYS WITH APPROPRIATE BARRICADES TO DETER PEDESTRIAN TRAFFIC THROUGH ANY WORK ZONE.

NOTE: CONTRACTOR SHALL TO MAINTAIN ALL ACCESSIBLE PEDESTRIAN PATHWAYS THROUGH MAY 10, 2015.

REVISIONS	
NO.	DATE

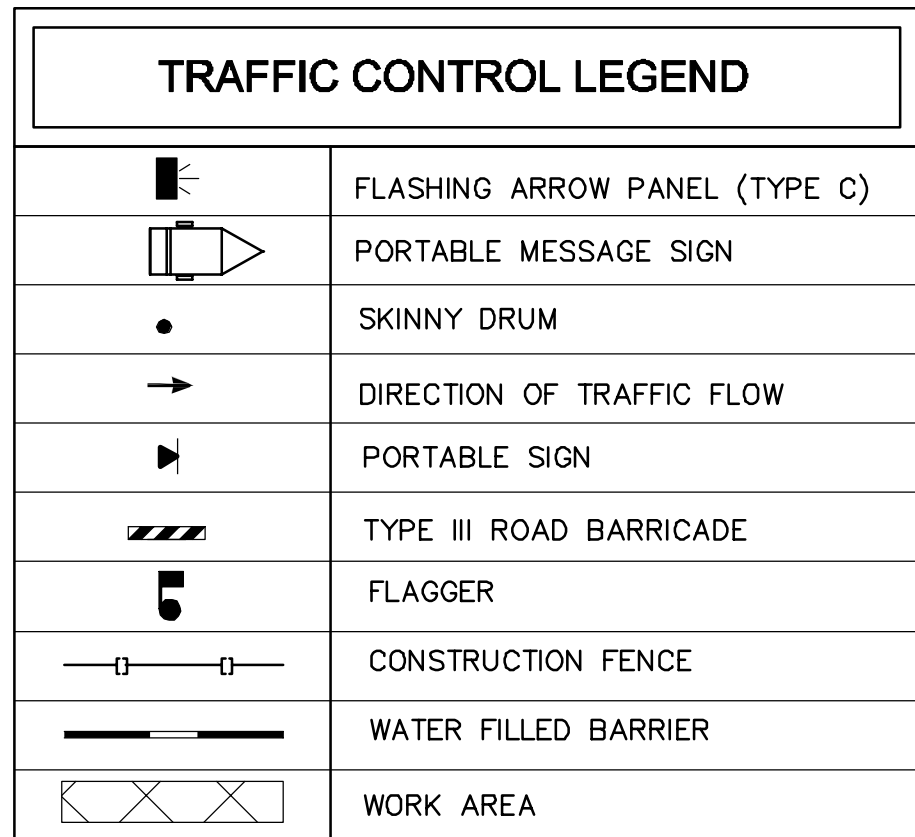

STEP 5: INSTALL FINAL PAVEMENT COURSE, FINAL PAVEMENT MARKINGS AND SIGNAGE.

<u>PAVEMENT MARKING LINES</u>		
PA	WHITE EDGE LINE	PAINT (4")
PB	WHITE PAVEMENT SYMBOL MARKINGS	
PI	YELLOW DOUBLE CENTER LINE	PAINT (4")
NOTE: CONTRACTOR TO REMOVE ALL CONFLICTING PAVEMENT MARKINGS		



DRAFT

[illegible]

CLIENT:

 UNC CHARLOTTE

9201 UNIVERSITY CITY BOULEVARD
CHARLOTTE, NC 28223

PROJECT: THE UNIVERSITY OF
NORTH CAROLINA AT CHARLOTTE
ROADWAY IMPROVEMENTS
CID-RI
CODE 41226 ITEM 301A
PROJECT ID#12-09457-02A









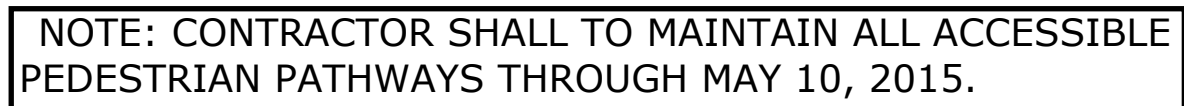

TITLE

TRAFFIC CONTROL
PHASE 5C

DESIGNED BY:	LL/GD
DRAWN BY:	DH
CHECKED BY:	BT
DATE:	12/12/2014
PROJECT#:	015124009

TC-12

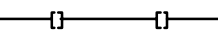

TRAFFIC CONTROL LEGEND	
	FLASHING ARROW PANEL (TYPE C)
	PORTABLE MESSAGE SIGN
	SKINNY DRUM
	DIRECTION OF TRAFFIC FLOW
	PORTABLE SIGN
	TYPE III ROAD BARRICADE
	FLAGGER
	CONSTRUCTION FENCE
	WATER FILLED BARRIER
	WORK AREA

ALT 2

PHASE 1:

STEP 1: INSTALL ALL ADVANCE WARNING SIGNAGE AND OTHER TRAFFIC CONTROL DEVICES THROUGHOUT PROJECT PRIOR TO BEGINNING CONSTRUCTION ACCORDING TO THE APPROPRIATE WATCH DIAGRAMS.

STEP 2: INSTALL EROSION CONTROL MEASURES THROUGHOUT THE PROJECT IN ACCORDANCE WITH THE EROSION CONTROL PLANS.

STEP 3: CONSTRUCT NEW CURB, GUTTER, SIDEWALK, DRAINAGE STRUCTURES, AND ASPHALT ALONG THE SOUTH SIDE OF CRAVER ROAD. MAINTAIN AT LEAST ONE THROUGH LANE IN EACH DIRECTION ALONG CRAVER ROAD. USE WATCH DIAGRAMS 4 AND 5 AS NECESSARY.

STEP 4: CONSTRUCT NEW CURB, GUTTER, SIDEWALK, DRAINAGE STRUCTURES, AND ASPHALT ALONG THE NORTH SIDE OF CRAVER ROAD. MAINTAIN AT LEAST ONE THROUGH LANE IN EACH DIRECTION ALONG CRAVER ROAD. USE WATCH DIAGRAMS 4 AND 5 AS NECESSARY.

STEP 5: INSTALL FINAL PAVEMENT COURSE, FINAL PAVEMENT MARKINGS AND SIGNAGE.

<u>PAVEMENT MARKING LINES</u>		
PA	WHITE EDGELINE	PAINT (4")
PB	WHITE PAVEMENT SYMBOL MARKINGS	
PI	YELLOW DOUBLE CENTER LINE	PAINT (4")
NOTE: CONTRACTOR TO REMOVE ALL CONFLICTING PAVEMENT MARKINGS		

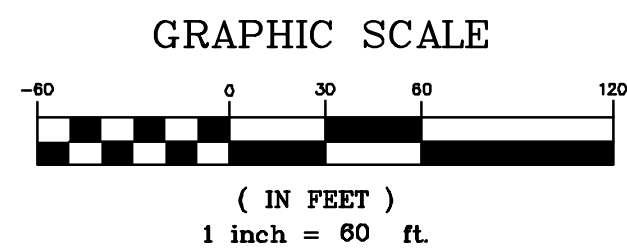

DRAFT

[illegible]

CLIENT:

 UNC CHARLOTTE

9201 UNIVERSITY CITY BOULEVARD
CHARLOTTE, NC 28223

PROJECT: THE UNIVERSITY OF
NORTH CAROLINA AT CHARLOTTE
ROADWAY IMPROVEMENTS
CID-RI
CODE 41226 ITEM 301A
PROJECT ID#12-09457-02A

TITLE: TRAFFIC CONTROL
PHASE 5D

DESIGNED BY:	LL/GD
DRAWN BY:	DH
CHECKED BY:	BT
DATE:	12/12/2014
PROJECT#:	015124009

TC-13

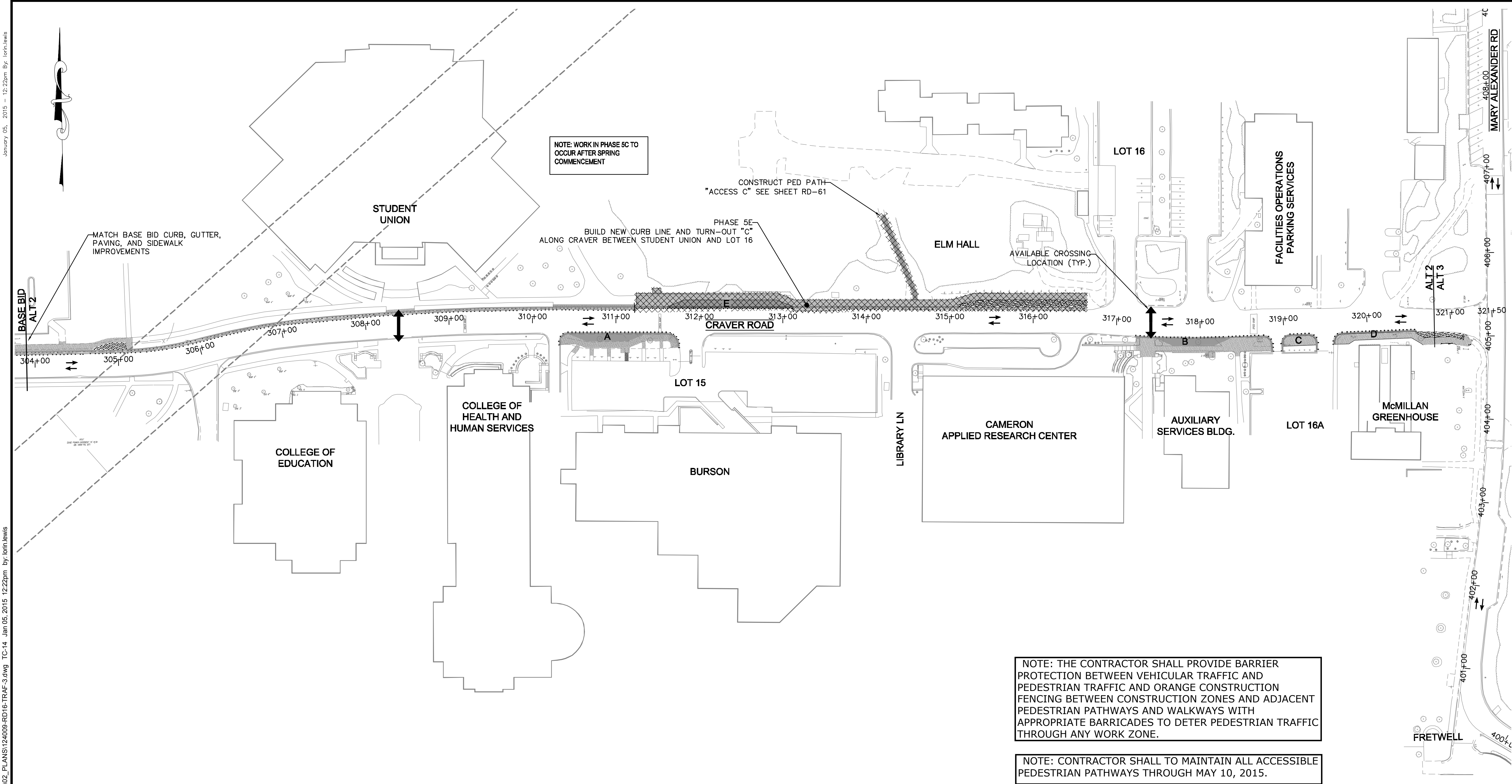

TRAFFIC CONTROL LEGEND	
	FLASHING ARROW PANEL (TYPE C)
	PORTABLE MESSAGE SIGN
	SKINNY DRUM
	DIRECTION OF TRAFFIC FLOW
	PORTABLE SIGN
	TYPE III ROAD BARRICADE
	FLAGGER
	CONSTRUCTION FENCE
	WATER FILLED BARRIER
	WORK AREA

CONSTRUCTION SEQUENCE:

ALT 2

- PHASE 1:
- STEP 1: INSTALL ALL ADVANCE WARNING SIGNAGE AND OTHER TRAFFIC CONTROL DEVICES THROUGHOUT PROJECT PRIOR TO BEGINNING CONSTRUCTION ACCORDING TO THE APPROPRIATE WATCH DIAGRAMS.
- STEP 2: INSTALL EROSION CONTROL MEASURES THROUGHOUT THE PROJECT IN ACCORDANCE WITH THE EROSION CONTROL PLANS.
- STEP 3: CONSTRUCT NEW CURB, GUTTER, SIDEWALK, DRAINAGE STRUCTURES, AND ASPHALT ALONG THE SOUTH SIDE OF CRAVER ROAD. MAINTAIN AT LEAST ONE THROUGH LANE IN EACH DIRECTION ALONG CRAVER ROAD. USE WATCH DIAGRAMS 4 AND 5 AS NECESSARY.
- STEP 4: CONSTRUCT NEW CURB, GUTTER, SIDEWALK, DRAINAGE STRUCTURES, AND ASPHALT ALONG THE NORTH SIDE OF CRAVER ROAD. MAINTAIN AT LEAST ONE THROUGH LANE IN EACH DIRECTION ALONG CRAVER ROAD. USE WATCH DIAGRAMS 4 AND 5 AS NECESSARY.
- STEP 5: INSTALL FINAL PAVEMENT COURSE, FINAL PAVEMENT MARKINGS AND SIGNAGE.

TEMPORARY PAVEMENT MARKING LEGEND

PAVEMENT MARKING LINES	
PA	WHITE EDGELINE
PB	WHITE PAVEMENT SYMBOL MARKINGS
PI	YELLOW DOUBLE CENTER LINE
	PAINT (4")
NOTE: CONTRACTOR TO REMOVE ALL CONFLICTING PAVEMENT MARKINGS	

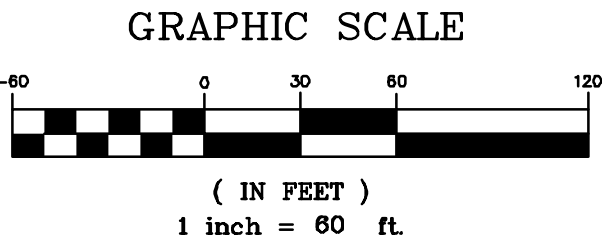

Know what's below.
Call before you dig.

Kimley»Horn
NC License #F-0102
2000 SOUTH BOULEVARD
SUITE 440
CHARLOTTE, NORTH
CAROLINA 28203
PHONE: (704) 333-5131
© 2014

DRAFT

REVISIONS	
NO.	DATE

CLIENT:

9201 UNIVERSITY CITY BOULEVARD
CHARLOTTE, NC 28223

PROJECT:
THE UNIVERSITY OF
NORTH CAROLINA AT CHARLOTTE
ROADWAY IMPROVEMENTS
CID-RI
CODE 41226 ITEM 301A
PROJECT ID#12-09457-02A

TITLE:
**TRAFFIC CONTROL
PHASE 5E**

DESIGNED BY: LL/GD
DRAWN BY: DH
CHECKED BY: BT
DATE: 12/12/2014
PROJECT#: 015124009

TC-14

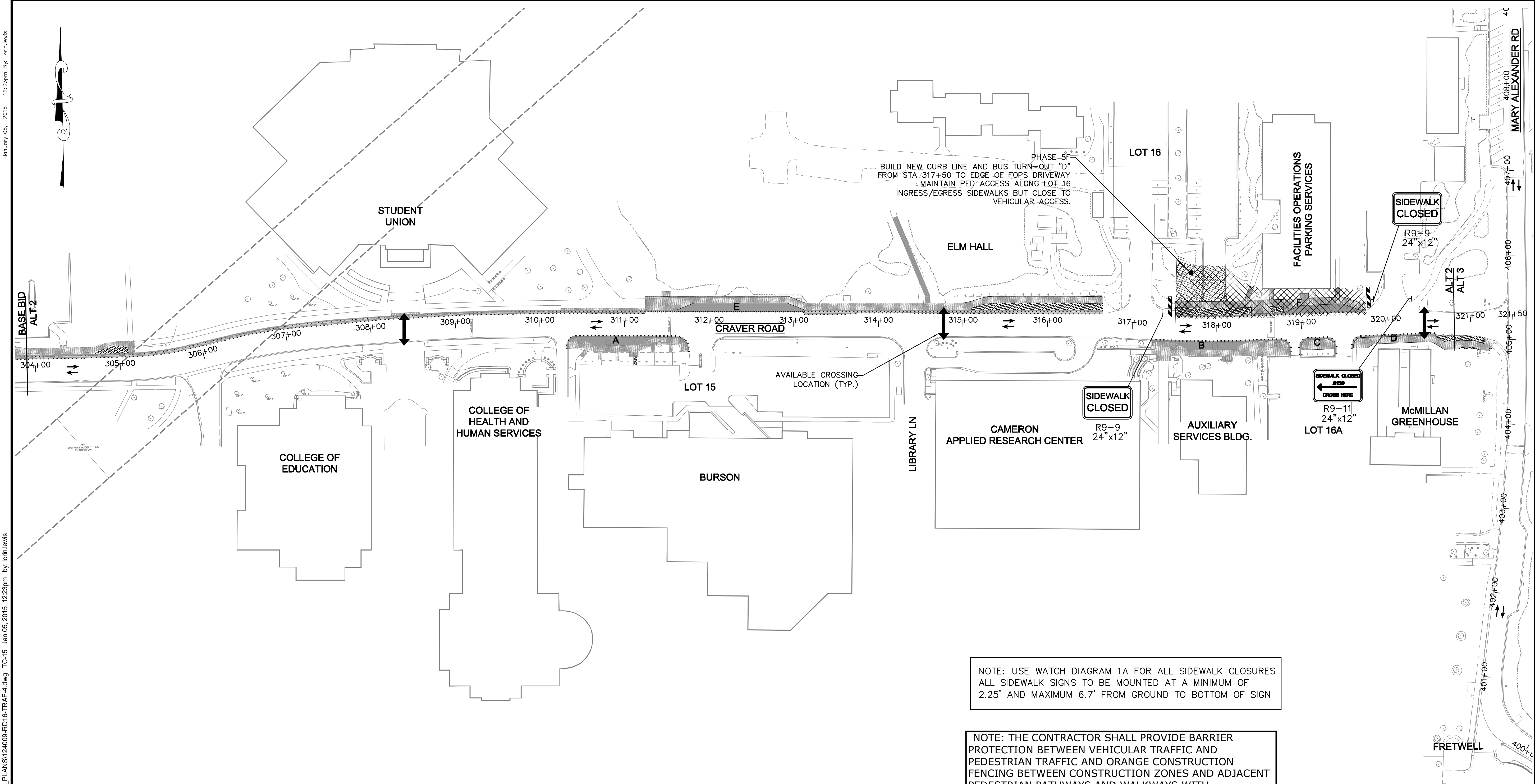

TRAFFIC CONTROL LEGEND	
	FLASHING ARROW PANEL (TYPE C)
	PORTABLE MESSAGE SIGN
	SKINNY DRUM
	DIRECTION OF TRAFFIC FLOW
	PORTABLE SIGN
	TYPE III ROAD BARRICADE
	FLAGGER
	CONSTRUCTION FENCE
	WATER FILLED BARRIER
	WORK AREA

CONSTRUCTION SEQUENCE:

ALT 2

- PHASE 1:
- STEP 1: INSTALL ALL ADVANCE WARNING SIGNAGE AND OTHER TRAFFIC CONTROL DEVICES THROUGHOUT PROJECT PRIOR TO BEGINNING CONSTRUCTION ACCORDING TO THE APPROPRIATE WATCH DIAGRAMS.
- STEP 2: INSTALL EROSION CONTROL MEASURES THROUGHOUT THE PROJECT IN ACCORDANCE WITH THE EROSION CONTROL PLANS.
- STEP 3: CONSTRUCT NEW CURB, GUTTER, SIDEWALK, DRAINAGE STRUCTURES, AND ASPHALT ALONG THE SOUTH SIDE OF CRAVER ROAD. MAINTAIN AT LEAST ONE THROUGH LANE IN EACH DIRECTION ALONG CRAVER ROAD. USE WATCH DIAGRAMS 4 AND 5 AS NECESSARY.
- STEP 4: CONSTRUCT NEW CURB, GUTTER, SIDEWALK, DRAINAGE STRUCTURES, AND ASPHALT ALONG THE NORTH SIDE OF CRAVER ROAD. MAINTAIN AT LEAST ONE THROUGH LANE IN EACH DIRECTION ALONG CRAVER ROAD. USE WATCH DIAGRAMS 4 AND 5 AS NECESSARY.
- STEP 5: INSTALL FINAL PAVEMENT COURSE, FINAL PAVEMENT MARKINGS AND SIGNAGE.

TEMPORARY PAVEMENT MARKING LEGEND

PAVEMENT MARKING LINES	
PA	WHITE EDGELINE
PB	WHITE PAVEMENT SYMBOL MARKINGS
PI	YELLOW DOUBLE CENTER LINE
NOTE: CONTRACTOR TO REMOVE ALL CONFLICTING PAVEMENT MARKINGS	

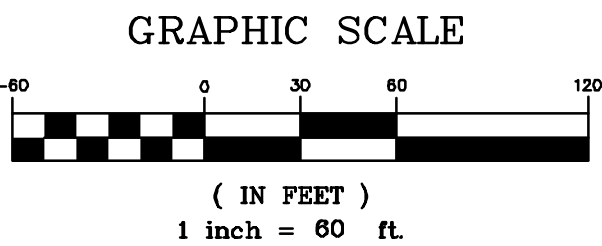

DRAFT

REVISIONS	
NO.	DATE

CLIENT:

9201 UNIVERSITY CITY BOULEVARD
CHARLOTTE, NC 28223

PROJECT:

THE UNIVERSITY OF
NORTH CAROLINA AT CHARLOTTE
ROADWAY IMPROVEMENTS

CID-RI
CODE 41226 ITEM 301A
PROJECT ID#12-09457-02A

TITLE:

TRAFFIC CONTROL
PHASE 5F

DESIGNED BY:	LL/GD
DRAWN BY:	DH
CHECKED BY:	BT
DATE:	12/12/2014
PROJECT:	015124009

TC-15

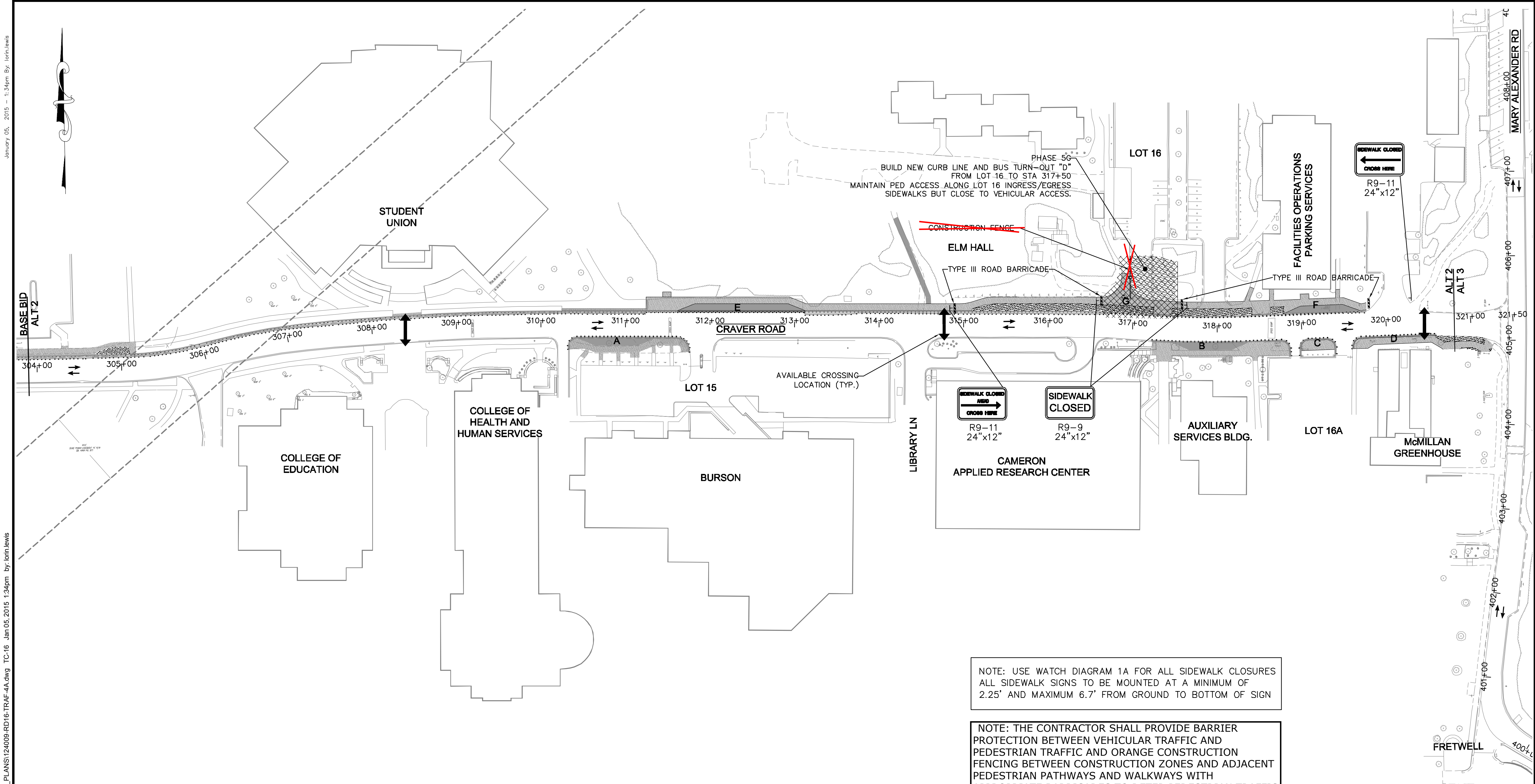

TRAFFIC CONTROL LEGEND	
	FLASHING ARROW PANEL (TYPE C)
	PORTABLE MESSAGE SIGN
	SKINNY DRUM
	DIRECTION OF TRAFFIC FLOW
	PORTABLE SIGN
	TYPE III ROAD BARRICADE
	FLAGGER
	CONSTRUCTION FENCE
	WATER FILLED BARRIER
	WORK AREA

CONSTRUCTION SEQUENCE:
ALT 2

- PHASE 1:
- STEP 1: INSTALL ALL ADVANCE WARNING SIGNAGE AND OTHER TRAFFIC CONTROL DEVICES THROUGHOUT PROJECT PRIOR TO BEGINNING CONSTRUCTION ACCORDING TO THE APPROPRIATE WATCH DIAGRAMS.
- STEP 2: INSTALL EROSION CONTROL MEASURES THROUGHOUT THE PROJECT IN ACCORDANCE WITH THE EROSION CONTROL PLANS.
- STEP 3: CONSTRUCT NEW CURB, GUTTER, SIDEWALK, DRAINAGE STRUCTURES, AND ASPHALT ALONG THE SOUTH SIDE OF CRAVER ROAD. MAINTAIN AT LEAST ONE THROUGH LANE IN EACH DIRECTION ALONG CRAVER ROAD. USE WATCH DIAGRAMS 4 AND 5 AS NECESSARY.
- STEP 4: CONSTRUCT NEW CURB, GUTTER, SIDEWALK, DRAINAGE STRUCTURES, AND ASPHALT ALONG THE NORTH SIDE OF CRAVER ROAD. MAINTAIN AT LEAST ONE THROUGH LANE IN EACH DIRECTION ALONG CRAVER ROAD. USE WATCH DIAGRAMS 4 AND 5 AS NECESSARY.
- STEP 5: INSTALL FINAL PAVEMENT COURSE, FINAL PAVEMENT MARKINGS AND SIGNAGE.

TEMPORARY PAVEMENT MARKING LEGEND

PAVEMENT MARKING LINES	
PA	WHITE EDGELINE
PB	WHITE PAVEMENT SYMBOL MARKINGS
PI	YELLOW DOUBLE CENTER LINE
	PAINT (4")
	PAINT (4")
NOTE: CONTRACTOR TO REMOVE ALL CONFLICTING PAVEMENT MARKINGS	

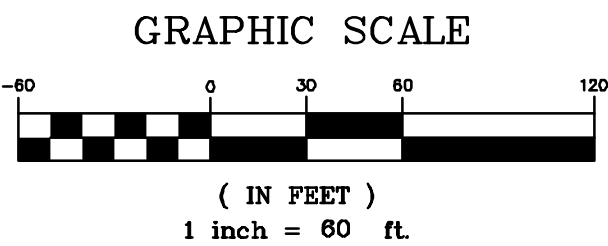

NOTE: USE WATCH DIAGRAM 1A FOR ALL SIDEWALK CLOSURES
ALL SIDEWALK SIGNS TO BE MOUNTED AT A MINIMUM OF 2.25' AND MAXIMUM 6.7' FROM GROUND TO BOTTOM OF SIGN

NOTE: THE CONTRACTOR SHALL PROVIDE BARRIER PROTECTION BETWEEN VEHICULAR TRAFFIC AND PEDESTRIAN TRAFFIC AND ORANGE CONSTRUCTION FENCING BETWEEN CONSTRUCTION ZONES AND ADJACENT PEDESTRIAN PATHWAYS AND WALKWAYS WITH APPROPRIATE BARRICADES TO DETER PEDESTRIAN TRAFFIC THROUGH ANY WORK ZONE.

NOTE: CONTRACTOR SHALL TO MAINTAIN ALL ACCESSIBLE PEDESTRIAN PATHWAYS THROUGH MAY 10, 2015.

REVISIONS	
NO.	DATE

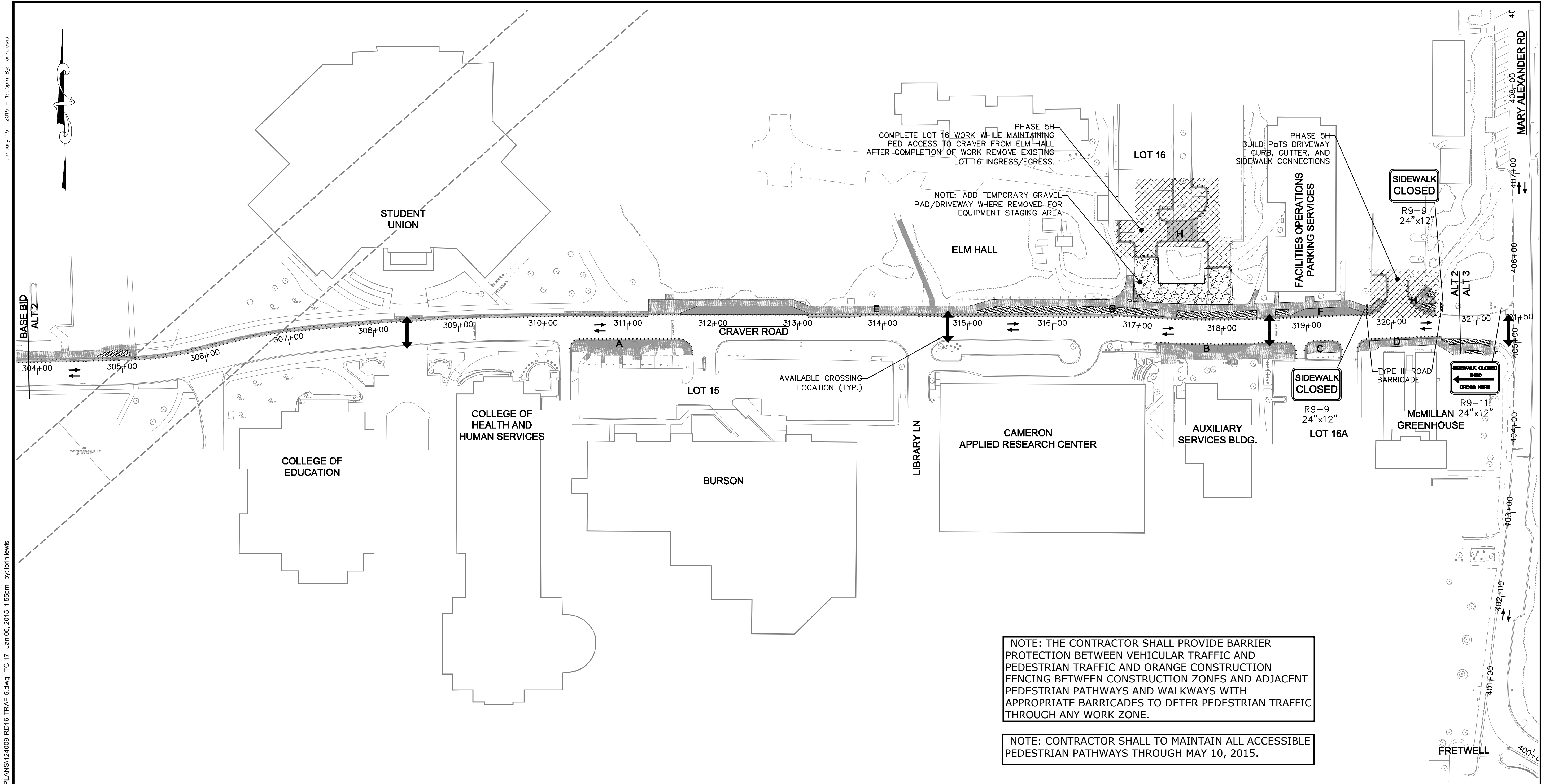

TRAFFIC CONTROL LEGEND	
	FLASHING ARROW PANEL (TYPE C)
	PORTABLE MESSAGE SIGN
	SKINNY DRUM
	DIRECTION OF TRAFFIC FLOW
	PORTABLE SIGN
	TYPE III ROAD BARRICADE
	FLAGGER
	CONSTRUCTION FENCE
	WATER FILLED BARRIER
	WORK AREA

CONSTRUCTION SEQUENCE:

ALT 2

- PHASE 1:
- STEP 1: INSTALL ALL ADVANCE WARNING SIGNAGE AND OTHER TRAFFIC CONTROL DEVICES THROUGHOUT PROJECT PRIOR TO BEGINNING CONSTRUCTION ACCORDING TO THE APPROPRIATE WATCH DIAGRAMS.
- STEP 2: INSTALL EROSION CONTROL MEASURES THROUGHOUT THE PROJECT IN ACCORDANCE WITH THE EROSION CONTROL PLANS.
- STEP 3: CONSTRUCT NEW CURB, GUTTER, SIDEWALK, DRAINAGE STRUCTURES, AND ASPHALT ALONG THE SOUTH SIDE OF CRAVER ROAD. MAINTAIN AT LEAST ONE THROUGH LANE IN EACH DIRECTION ALONG CRAVER ROAD. USE WATCH DIAGRAMS 4 AND 5 AS NECESSARY.
- STEP 4: CONSTRUCT NEW CURB, GUTTER, SIDEWALK, DRAINAGE STRUCTURES, AND ASPHALT ALONG THE NORTH SIDE OF CRAVER ROAD. MAINTAIN AT LEAST ONE THROUGH LANE IN EACH DIRECTION ALONG CRAVER ROAD. USE WATCH DIAGRAMS 4 AND 5 AS NECESSARY.
- STEP 5: INSTALL FINAL PAVEMENT COURSE, FINAL PAVEMENT MARKINGS AND SIGNAGE.

TEMPORARY PAVEMENT MARKING LEGEND

PAVEMENT MARKING LINES	
PA	WHITE EDGELINE
PB	WHITE PAVEMENT SYMBOL MARKINGS
PI	YELLOW DOUBLE CENTER LINE
NOTE: CONTRACTOR TO REMOVE ALL CONFLICTING PAVEMENT MARKINGS	

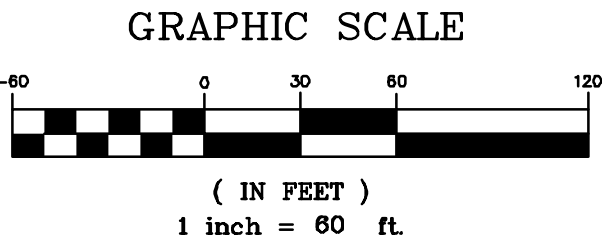

DRAFT

NO.	DATE	REVISIONS

CLIENT:

9201 UNIVERSITY CITY BOULEVARD
CHARLOTTE, NC 28223

PROJECT:

THE UNIVERSITY OF
NORTH CAROLINA AT CHARLOTTE
ROADWAY IMPROVEMENTS

CID-RI
CODE 41226 ITEM 301A
PROJECT ID#12-09457-02A

TITLE:

TRAFFIC CONTROL
PHASE 5H

DESIGNED BY:	LL/GD
DRAWN BY:	DH
CHECKED BY:	BT
DATE:	12/12/2014
PROJECT#:	015124009

TC-17

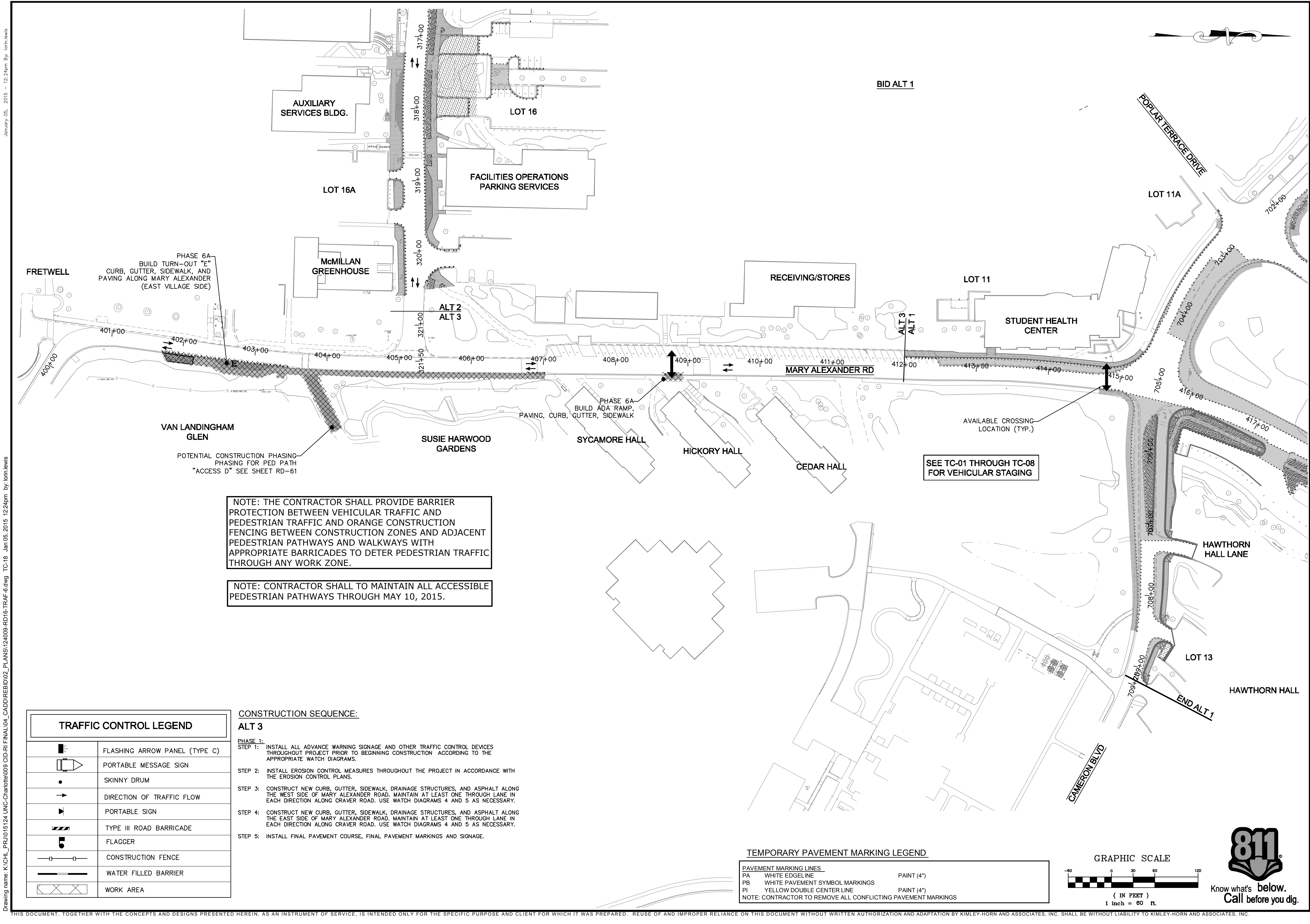

NOTE: THE CONTRACTOR SHALL PROVIDE BARRIER PROTECTION BETWEEN VEHICULAR TRAFFIC AND PEDESTRIAN TRAFFIC AND ORANGE CONSTRUCTION FENCING BETWEEN CONSTRUCTION ZONES AND ADJACENT PEDESTRIAN PATHWAYS AND WALKWAYS WITH APPROPRIATE BARRICADES TO DETER PEDESTRIAN TRAFFIC THROUGH ANY WORK ZONE.

NOTE: CONTRACTOR SHALL TO MAINTAIN ALL ACCESSIBLE PEDESTRIAN PATHWAYS THROUGH MAY 10, 2015.

TRAFFIC CONTROL LEGEND	
	FLASHING ARROW PANEL (TYPE C)
	PORTABLE MESSAGE SIGN
	SKINNY DRUM
	DIRECTION OF TRAFFIC FLOW
	PORTABLE SIGN
	TYPE III ROAD BARRICADE
	FLAGGER
	CONSTRUCTION FENCE
	WATER FILLED BARRIER
	WORK AREA

- CONSTRUCTION SEQUENCE:
- ALT 3**
- PHASE 1:
- STEP 1: INSTALL ALL ADVANCE WARNING SIGNAGE AND OTHER TRAFFIC CONTROL DEVICES THROUGHOUT PROJECT PRIOR TO BEGINNING CONSTRUCTION ACCORDING TO THE APPROPRIATE WATCH DIAGRAMS.
- STEP 2: INSTALL EROSION CONTROL MEASURES THROUGHOUT THE PROJECT IN ACCORDANCE WITH THE EROSION CONTROL PLANS.
- STEP 3: CONSTRUCT NEW CURB, GUTTER, SIDEWALK, DRAINAGE STRUCTURES, AND ASPHALT ALONG THE WEST SIDE OF MARY ALEXANDER ROAD. MAINTAIN AT LEAST ONE THROUGH LANE IN EACH DIRECTION ALONG CRAVER ROAD. USE WATCH DIAGRAMS 4 AND 5 AS NECESSARY.
- STEP 4: CONSTRUCT NEW CURB, GUTTER, SIDEWALK, DRAINAGE STRUCTURES, AND ASPHALT ALONG THE EAST SIDE OF MARY ALEXANDER ROAD. MAINTAIN AT LEAST ONE THROUGH LANE IN EACH DIRECTION ALONG CRAVER ROAD. USE WATCH DIAGRAMS 4 AND 5 AS NECESSARY.
- STEP 5: INSTALL FINAL PAVEMENT COURSE, FINAL PAVEMENT MARKINGS AND SIGNAGE.

TEMPORARY PAVEMENT MARKING LEGEND

PAVEMENT MARKING LINES	
PA	WHITE EDGELINE
PB	WHITE PAVEMENT SYMBOL MARKINGS
PI	YELLOW DOUBLE CENTER LINE
NOTE: CONTRACTOR TO REMOVE ALL CONFLICTING PAVEMENT MARKINGS	
PAINT (4")	
PAINT (4")	

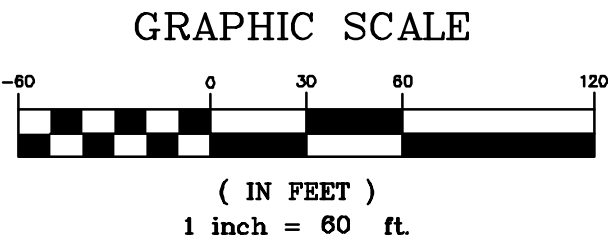

Kimley»Horn

NC License #F-0102
2000 SOUTH BOULEVARD
SUITE 440
CHARLOTTE, NORTH
CAROLINA 28203
PHONE: (704) 333-5131
© 2014

DRAFT

NO.	DATE	REVISIONS

CLIENT:

UNC CHARLOTTE

9201 UNIVERSITY CITY BOULEVARD
CHARLOTTE, NC 28223

PROJECT:

THE UNIVERSITY OF
NORTH CAROLINA AT CHARLOTTE
ROADWAY IMPROVEMENTS

CID-RI
CODE 41226 ITEM 301A
PROJECT ID#12-09457-02A

TITLE:

**TRAFFIC CONTROL
PHASE 6A**

DESIGNED BY: LL/GD

DRAWN BY: DH

CHECKED BY: BT

DATE: 12/12/2014

PROJECT#: 015124009

TC-18

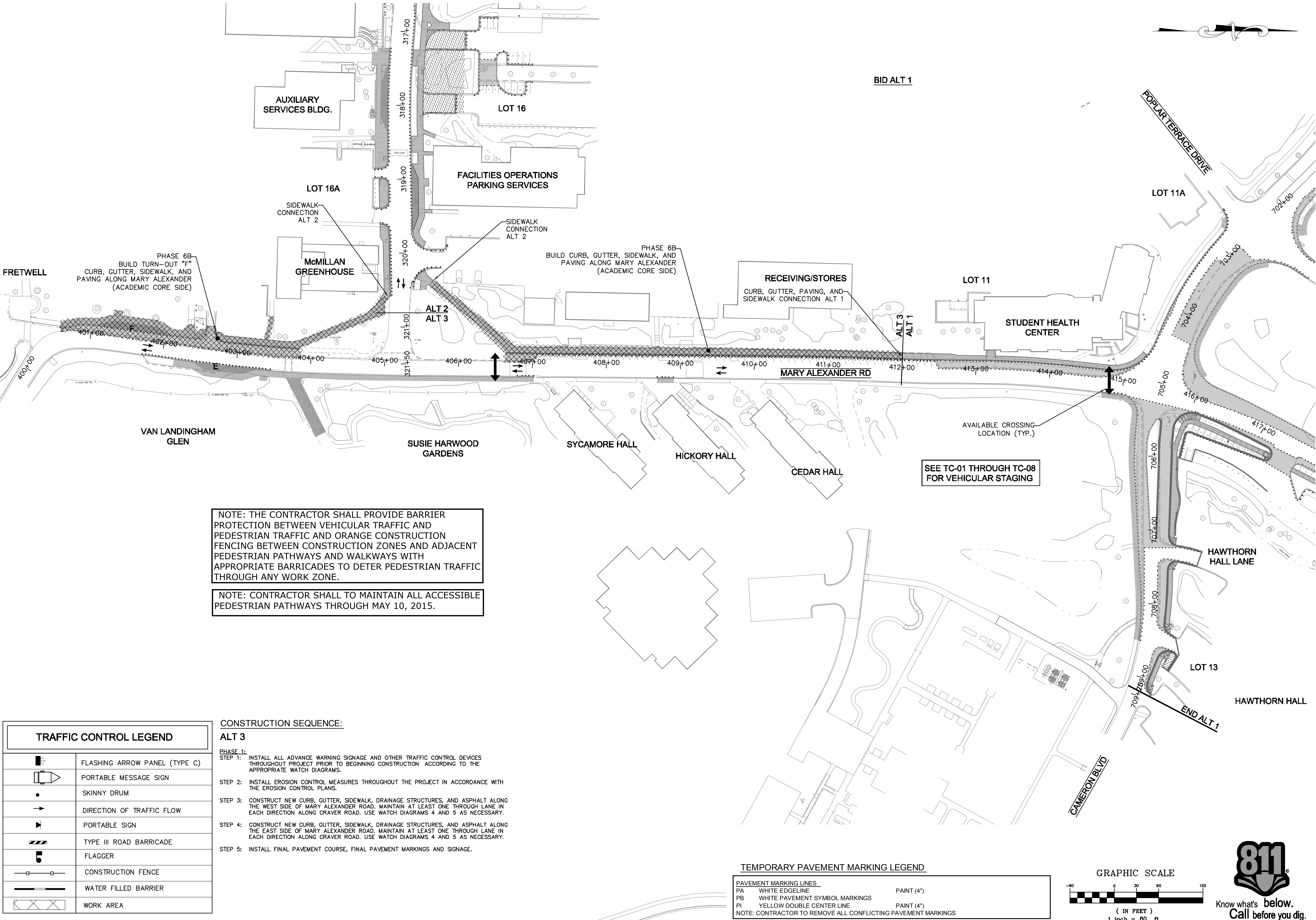

NO.	DATE	REVISIONS

UNC CHARLOTTE
9201 UNIVERSITY CITY BOULEVARD
CHARLOTTE, NC 28223

PROJECT: THE UNIVERSITY OF NORTH CAROLINA AT CHARLOTTE ROADWAY IMPROVEMENTS
CID-RI: CODE 41226 ITEM 301A
PROJECT ID#: 12-09457-02A

TRAFFIC CONTROL PHASE 6B

DESIGNED BY: LL/GD
DRAWN BY: DH
CHECKED BY: BT
DATE: 12/12/2014
PROJECT: 015124009

January 05, 2015 -- 12:25pm By: tom.lewis

Drawing name: K:\CHL_PRJ\015124 UNC-Charlotte\009 CID-RI FINAL\04_CADD\REBID\02_PLANS\124006-RD16-TRAF-B.dwg TC-20 Jan 05, 2015 12:25pm by: tom.lewis

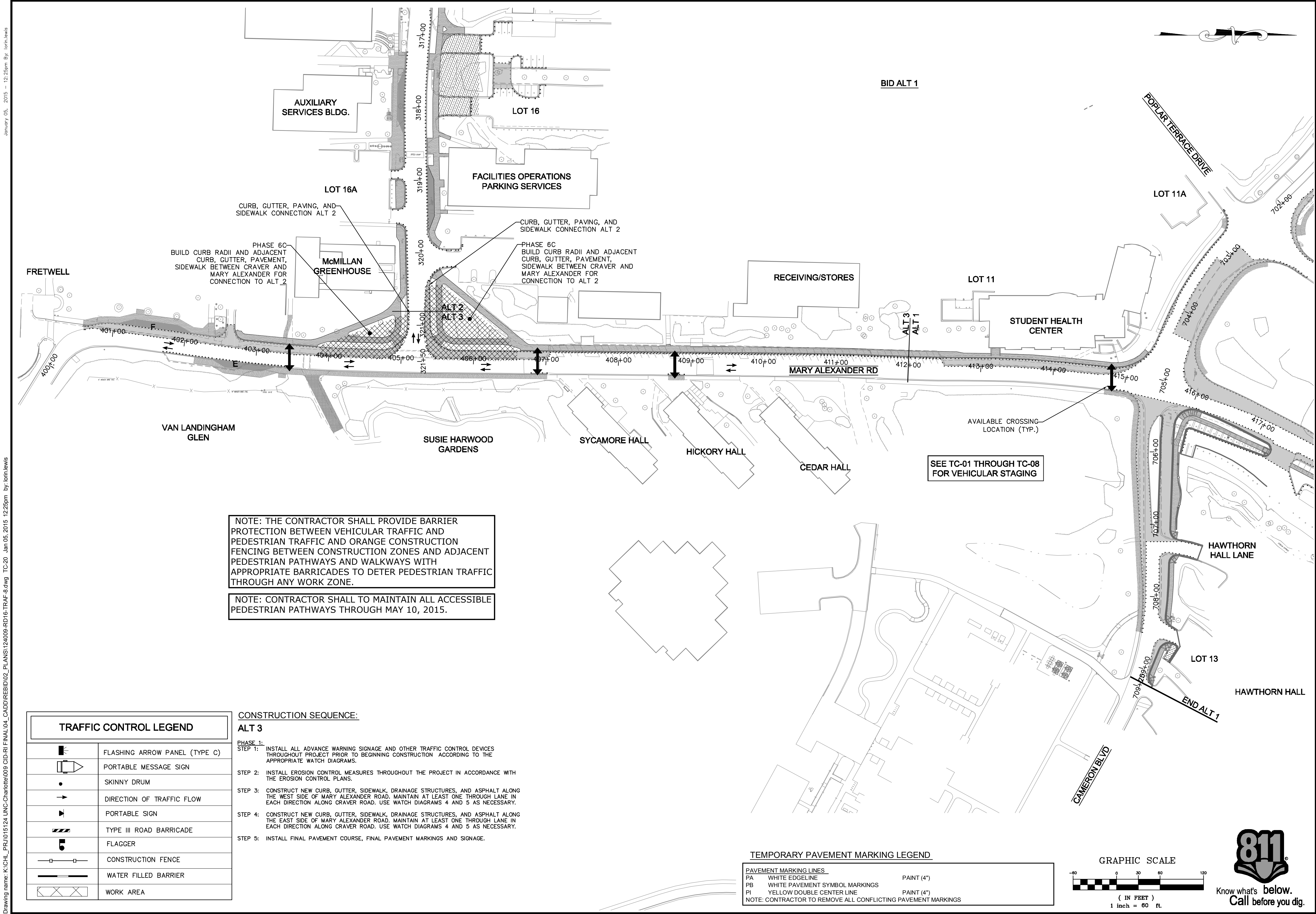

NOTE: THE CONTRACTOR SHALL PROVIDE BARRIER PROTECTION BETWEEN VEHICULAR TRAFFIC AND PEDESTRIAN TRAFFIC AND ORANGE CONSTRUCTION FENCING BETWEEN CONSTRUCTION ZONES AND ADJACENT PEDESTRIAN PATHWAYS AND WALKWAYS WITH APPROPRIATE BARRICADES TO DETER PEDESTRIAN TRAFFIC THROUGH ANY WORK ZONE.

NOTE: CONTRACTOR SHALL TO MAINTAIN ALL ACCESSIBLE PEDESTRIAN PATHWAYS THROUGH MAY 10, 2015.

TRAFFIC CONTROL LEGEND	
	FLASHING ARROW PANEL (TYPE C)
	PORTABLE MESSAGE SIGN
	SKINNY DRUM
	DIRECTION OF TRAFFIC FLOW
	PORTABLE SIGN
	TYPE III ROAD BARRICADE
	FLAGGER
	CONSTRUCTION FENCE
	WATER FILLED BARRIER
	WORK AREA

- CONSTRUCTION SEQUENCE:
- ALT 3**
- PHASE 1:
- STEP 1: INSTALL ALL ADVANCE WARNING SIGNAGE AND OTHER TRAFFIC CONTROL DEVICES THROUGHOUT PROJECT PRIOR TO BEGINNING CONSTRUCTION ACCORDING TO THE APPROPRIATE WATCH DIAGRAMS.
- STEP 2: INSTALL EROSION CONTROL MEASURES THROUGHOUT THE PROJECT IN ACCORDANCE WITH THE EROSION CONTROL PLANS.
- STEP 3: CONSTRUCT NEW CURB, GUTTER, SIDEWALK, DRAINAGE STRUCTURES, AND ASPHALT ALONG THE WEST SIDE OF MARY ALEXANDER ROAD. MAINTAIN AT LEAST ONE THROUGH LANE IN EACH DIRECTION ALONG CRAVER ROAD. USE WATCH DIAGRAMS 4 AND 5 AS NECESSARY.
- STEP 4: CONSTRUCT NEW CURB, GUTTER, SIDEWALK, DRAINAGE STRUCTURES, AND ASPHALT ALONG THE EAST SIDE OF MARY ALEXANDER ROAD. MAINTAIN AT LEAST ONE THROUGH LANE IN EACH DIRECTION ALONG CRAVER ROAD. USE WATCH DIAGRAMS 4 AND 5 AS NECESSARY.
- STEP 5: INSTALL FINAL PAVEMENT COURSE, FINAL PAVEMENT MARKINGS AND SIGNAGE.

TEMPORARY PAVEMENT MARKING LEGEND

PAVEMENT MARKING LINES	
PA	WHITE EDGELINE
PB	WHITE PAVEMENT SYMBOL MARKINGS
PI	YELLOW DOUBLE CENTER LINE
NOTE: CONTRACTOR TO REMOVE ALL CONFLICTING PAVEMENT MARKINGS	
PAINT (4")	
PAINT (4")	

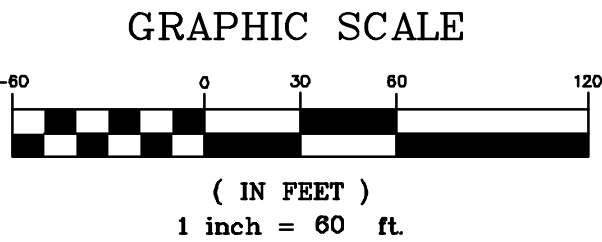

Kimley»Horn

NC License #F-0102
2000 SOUTH BOULEVARD
SUITE 440
CHARLOTTE, NORTH
CAROLINA 28203
PHONE: (704) 333-5131
© 2014

DRAFT

NO.	DATE	REVISIONS

UNC CHARLOTTE

CLIENT: 9201 UNIVERSITY CITY BOULEVARD
CHARLOTTE, NC 28223

PROJECT: THE UNIVERSITY OF
NORTH CAROLINA AT CHARLOTTE
ROADWAY IMPROVEMENTS

CID-RI
CODE 41226 ITEM 301A
PROJECT ID#12-09457-02A

TITLE: **TRAFFIC CONTROL
PHASE 6C**

DESIGNED BY: LL/GD
DRAWN BY: DH
CHECKED BY: BT
DATE: 12/12/2014
PROJECT: 015124009

TC-20

UNC Charlotte
“Good Faith Effort” Requirements
(Jan2015)

This information is provided as a guide for firms who may be new to UNC Charlotte and may not be familiar with our expectations regarding minority business participation on Formal (\$500,000 and above) construction projects. Bidders should be familiar with the ***Guidelines for Recruitment & Selection of Minority Businesses for Participation in State Construction Contracts*** as well as the applicable bid forms;

Identification of HUB Certified/Minority Business Participation form – Only list minority firms that you will use as construction subcontractors, vendors, suppliers or professional service providers on this project. The bidder cannot list himself on this form as he cannot subcontract to himself. **Note:** This form should be submitted with your bid, even if left blank.

Affidavit A – Listing of Good Faith Efforts – the bidder is certifying that he has made a good faith effort to comply under those areas checked on the form. Do not check a Good Faith Effort item unless you can provide the following;

1. Contacting minority businesses that reasonably could have been expected to submit a quote and that were known to the contractor or available on State or local government maintained lists **at least 10 days before the bid or proposal date** and notifying them of the nature and scope of the work to be performed.

Example: Copies of written (emailed or faxed) notification to minority businesses and copies of quotes/proposals received for work solicited to minority businesses. Notification should include, at a minimum, project location, location where plans and specifications may be obtained or viewed, trade or scopes of work for which subcontracts are being solicited, contact person within the prime contractor organization.

Be sure to maintain a telephone log to confirm that minority firms received your IFB. The log should contain the date contacted, telephone number, and name of the individual representing the minority firm who acknowledged receipt of your IFB. ***Also maintain a telephone log to confirm that minority firms acknowledged a “bid/no bid” to your IFB.*** The log should contain the date contacted, telephone number, and name of the individual representing the minority firm who acknowledged “bid/no bid” to your IFB.

2. Making the construction plans, specifications and requirements available for review by prospective minority businesses, or providing these documents to them at least 10 days before the bid or proposals are due.

Example: Copies of written (emailed or faxed) notification to minority businesses should include, at a minimum, project location, location where plans and specifications may be obtained or viewed, trade or scopes of work for which subcontracts are being solicited, contact person within the prime contractor organization.

3. Breaking down or combining elements of work into economically feasible units to facilitate minority participation.

Example: Document steps taken to segment elements of work into economically feasible units to meet minority business availability. Identify sub-contractors/suppliers/consultants and scope of work involved in segmenting.

Be sure that you are soliciting quotes from **at least** three (3) minority firms in scopes of work that typically have adequate numbers of minority firms available that can perform the work required (hauling, concrete, flooring, masonry, painting, electrical suppliers, etc.). Do not solicit quotes

from minority firms in those scopes of work that typically do not have minority firms available that can perform the work required (elevators, fire suppression systems, roofing, etc.). If there are minority firms that you typically use on your projects then by all means, feel free to use them, if you are sure you are receiving reasonable pricing and quality work.

4. Working with minority trade, community or contractor organization identified by the Office for Historically Underutilized Businesses (HUB) and included in the bid documents that provide assistance in recruitment of minority businesses. **Note:** Minority plan rooms are not applicable.

Example: Provide a copy of meeting minutes between prime contractor and minority trade, community or contractor organization. At minimum the following topics should be discussed/reviewed during the meeting: project location; location where plans and specifications may be obtained or viewed; trade or scopes of work for which subcontracts are being solicited; bonding requirements; insurance requirements; prime contractor's contact person; minority trade, community or contractor organization contact person; strategies to segment elements of the work into economically feasible units to meet minority business availability; strategies to increase minority business utilization through joint ventures and/or partnerships; notification that the meeting will be counted toward the contractor's good faith effort.

Example: Maintain a copy of the request, and have the date, telephone number and name of the individual who acknowledged receipt of your request and information regarding any/all assistance provided by the organization

5. Attending any pre-bid meetings scheduled by the public owner.

Example: Attendance will be verified by conference sign-in sheet.

6. Providing assistance in getting required bonding or insurance or providing alternatives to bonding or insurance for subcontractors.

Example: Documentation describing the type of assistance provided or offered to minority businesses. Provide names and contacts of minority businesses to which assistance was offered and names of the contact person of bonding companies or financial institutions offering assistance.

7. Negotiating in good faith with interested minority businesses and not rejecting them as unqualified without sound reasons based on their capabilities. Any rejection of a minority business based on lack of qualification should have the reasons documented in writing.

Example: Document number of bids received from minority businesses in the trade or scopes of work for which subcontracts are being solicited, the number of minority businesses that submitted low bids or proposals, the number of minority businesses the bidder has offered to negotiate prices or services, and the number of minority businesses the bidder has agreed to utilize on the project, outline steps taken.

8. Providing assistance to an otherwise qualified minority business in need of equipment, loan capital, lines of credit, or joint pay agreements to secure loans, supplies, or letters of credit, including waiving credit that is ordinarily required or assisting minority businesses in obtaining the same unit pricing with the bidders supplier.

Example: Document names, addresses and telephone numbers of minority businesses to which assistance was offered, outline steps taken. Give dates assistance was offered and document outcome.

9. Negotiating joint venture and partnership arrangements with minority businesses in order to increase opportunities for minority business participation on a public construction or repair project when possible.

Example: Provide a copy of joint venture or partnership arrangements between bidder and minority business.

10. Providing quick pay agreements and policies to enable minority contractors and suppliers to meet cash-flow demands.

Example: Provide a copy of quick pay agreements and/or policies and document the number of minority businesses that will utilize the quick pay agreement. Provide a copy of the quick pay agreement between bidder and minority business.

Note: *Referencing the Good Faith Efforts listed above in your IFB is not enough. You must be able to document your efforts.*

Affidavit B – Intent to Perform Contract with Own Workforce – In making this certification the bidder is stating that he does not customarily subcontract elements of this type project and normally performs and has the capability to perform and will perform all elements of the work on this project with his own current workforce. The bidder agrees to make a Good Faith Effort to utilize minority suppliers where possible. “**Self-performing**” means the contractor has all equipment, personnel and supplies on hand to perform the contract. If the contractor needs to purchase supplies or rent equipment and operators to perform the work, then the contractor **is not** self-performing and should make efforts to purchase supplies or equipment, or temporary labor from minority firms. **Note:** No other Affidavits are required if the Bidder meets this criteria.

Affidavit C – Portion of the Work to be Performed by HUB Certified/Minority Businesses – This form is to be submitted only by the apparent lowest responsible, responsive bidder with equal to or greater than 10% minority participation.

Affidavit D – Good Faith Efforts – This form is to be submitted only by the apparent lowest responsible, responsive bidder with less than 10% minority participation along with their backup documentation.

Minority-owned Pre-qualified Bidders – **must also** meet the minority participation goals set for the project. Work performed by the minority-owned pre-qualified bidder will be counted towards the minority participation goal **only if** the minority contractor is **self-performing** and submitted Affidavit B.

Certification Requirements – Ensure the minority firms you contact for subcontracting opportunities are listed in the Statewide Uniform Certification (SWUC) Vendor database as **only firms** listed in the SWUC Vendor database, at the time of contract award, **will be counted** towards the minority participation goal for this project. Go to <http://www.doa.nc.gov/hub/searchhub.aspx> for access to the SWUC Vendor database.

Assistance:

Email the UNC Charlotte HUB Coordinator, Dorothy Vick (704-687-0527), **no later than 3:00PM Thursday, January 15, 2015** at dlvick@uncc.edu (**Email Subject: CID Roadway – Phase 2**) for the following;

1. **Assistance in finding certified minority firms who have worked on UNC Charlotte projects and who can perform the scopes of work (site work, concrete, electrical, etc.) you are seeking,** and/or
2. **A list of minority trade, community or contractor organizations** identified by the Office for Historically Underutilized Businesses that provide assistance in recruitment of minority businesses.

The HUB participation goal for this project is fifteen percent (15%).